

Instructions for clutch kit and clutch

44514 and 39133

ANV149

EN

Make sure that the flywheel's dimensions conform to the drawing before installing a new clutch!

If not, the flywheel has to be machined.

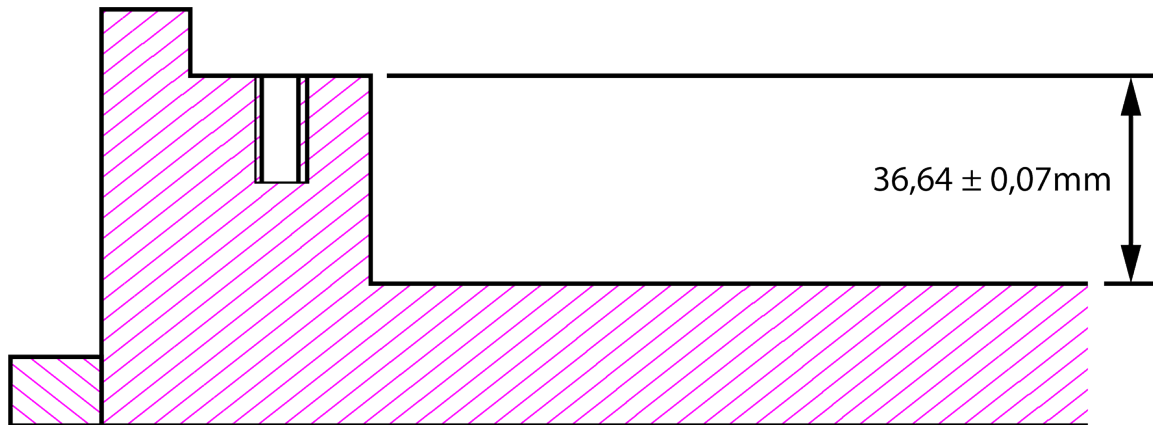

It is important to take care when assembling the two halves of the tractor.

This particular clutch type has a weak construction. It is therefore particularly important to take care during assembly in order to avoid installation damage to the plate and clutch.

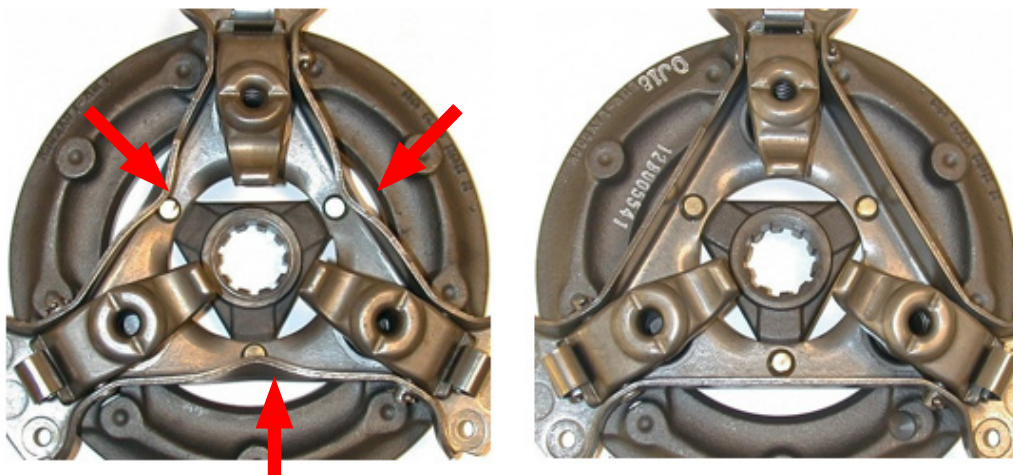

2024-06-20



Olssons i Ellös AB • Tel. +46 304-751010
Slätthultsvägen 12 • S-474 31 Ellös
www.olssonparts.com • order@olssonparts.com

General instruction to replace the clutch on the tractor

ANV127

EN

A few important points that are worth highlighting in connection with replacing the clutch on a tractor:

- The flywheel must be machined in accordance with the tractor manufacturer's specifications. If this is not done, there is a considerable risk that the new clutch will not work as expected, which will result in a great deal of work dismantling the tractor again.
- Take care centring the clutch plate and any power take-off plate during assembly. This should ideally be performed with a centring tool.
- When reassembling the tractor, take care and ensure that splines in plates and on shafts slide into each other without damaging the plates. Do not force the tractor together with the bolts.



Before the tractor is opened:
Make sure that the tractor is jacked firmly and that the tractor can be adjusted vertically during reassembly.

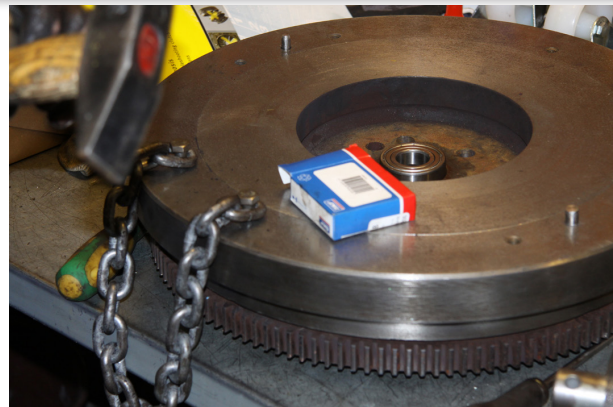

After dismantling the flywheel **must** be machined according to the manufacturer's instructions. Fit a new flywheel bearing.



Ensure that there is no leakage around the crankshaft. If there any leaking oil, the crankshaft seal needs to be replaced.



Check the release bearing mechanism with regard to wear and damage. Replace the release bearing. Check that the bearing holder slides easily. Check that the splines are undamaged. Clean the pin's splines and lubricate moderately with special grease.

2024-06-20



Olsson Parts.

Olssons i Ellös AB • Tel. +46 304-751010
Slätthultsvägen 12 • S-474 31 Ellös
www.olssonparts.com • order@olssonparts.com

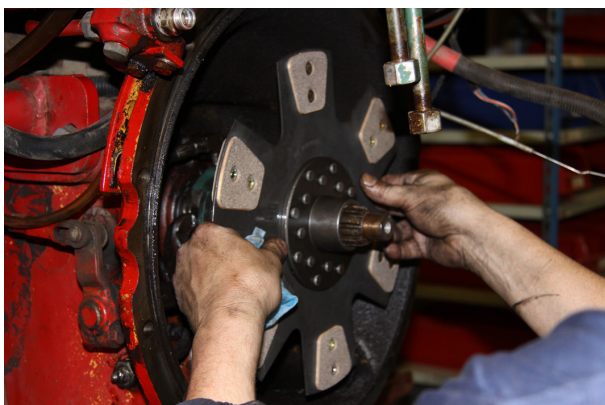

Check that the new plate slides easily on the pin's splines.

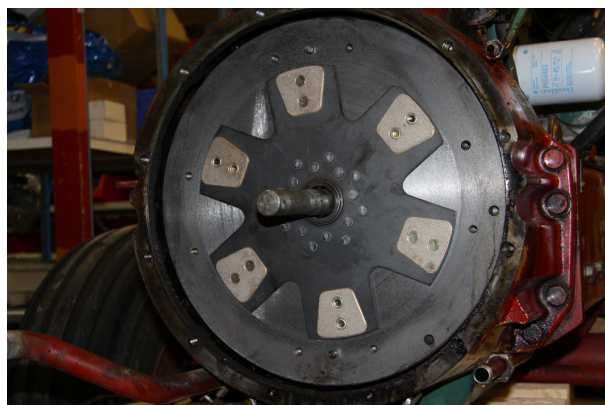

Make sure to centre the plate when assembling the clutch. Use a mandrel intended for this purpose.

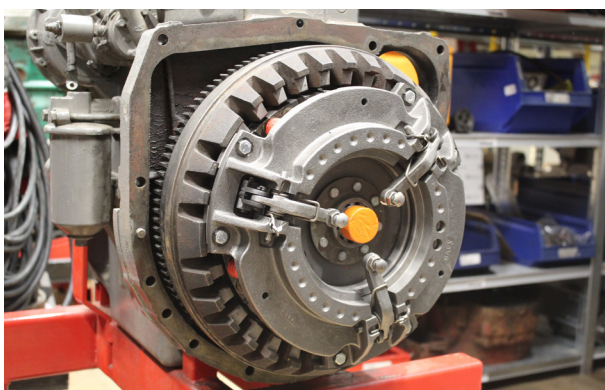

In the case of a double clutch, both the plates must be in the centre.



Do not forget to remove the transport locks when dismantling the clutch.

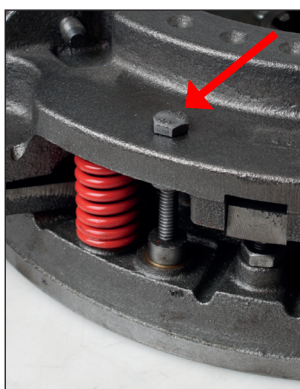

Different types of transport locks. Make sure that the transport locks have been removed before assembling the tractor!

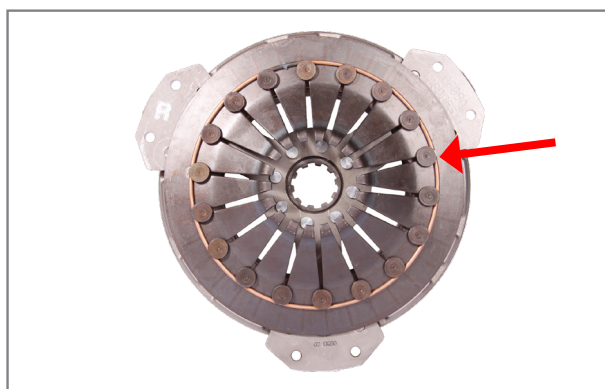

NOTE! This is NOT a transport lock and must not be dismantled.



Olsson Parts.

Olssons i Ellös AB • Tel. +46 304-751010
Slätthultsvägen 12 • S-474 31 Ellös
www.olssonparts.com • order@olssonparts.com

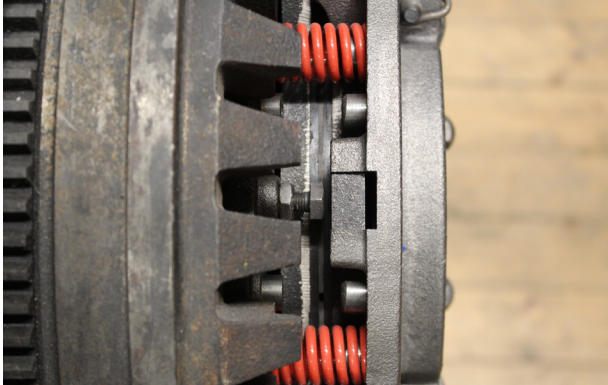

Any adjustments can be performed now.

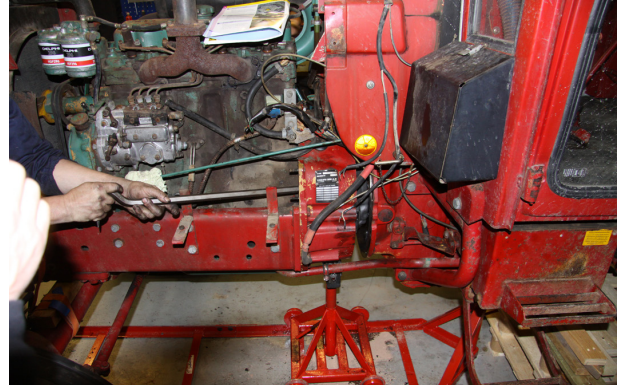

Exercise care to ensure the tractor's both halves are centred in height and laterally when assembling. If this is not the case, installation damage can occur the plate and clutch.



Make sure that the splines on the gearbox's input pin and the power take-off's drive slide easily in position on the clutch. Do not force the tractor halves with the bolts! Damage during installation is not covered by the warranty. The position of the power take-off's position is adjusted here when the power take-off is in the engaged position (independent position). This applies to mechanical power take-offs.

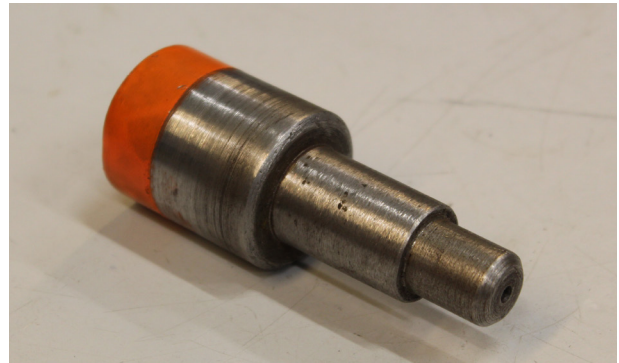

This is an example of a centring mandrel for a double clutch.

If the tractor has hydraulic release bearings, the correct type of hydraulic fluid must be used otherwise the seals will be damaged.

Exercise care when adjusting the pedal play once the installation is completed.

NOTE: This is general advice. First and foremost make sure to follow each tractor's workshop manual.